

- Type:** Compression  
**Material:** Stainless Steel  
**Protection:** IP 68  
**Features:** High Accuracy  
 Four Columns Construction  
**Application:** Weighbridge Road  
 Weighbridge Rail  
 Truck & Silo Scales  
 Hopper Weigher



*Specifications:*

Capacity	t	10 / 25 / 40 / 60 / 100 / 225 / 450
Accuracy Class		<b>C3</b>
Max. Number of Verification Intervals	$n_{max}$	3000
Minimum Load cell Verification Interval	$V_{min}$	$E_{max}/10000$
Temperature Effect on Zero	%FS/10°C	$\leq \pm 0.0175$
Temperature Effect on Sensitivity	%FS/10°C	$\leq \pm 0.0120$
Combined Error	%FS	$\leq \pm 0.0200$
Creep	%FS	$\leq \pm 0.0168$
Output Sensitivity	mv/v	$2.0 \pm 0.002$
Input Resistance	$\Omega$	$450 \pm 5$
Output Resistance	$\Omega$	$480 \pm 5$
Insulation Resistance	M $\Omega$	$\geq 5000$
Zero Balance	%FS	1.0
Temperature, Compensated	°C	-10 ~ +40
Temperature, Operating	°C	-40 ~ +80
Excitation, Recommended	v	5 ~ 15(DC)
Safe Overload	%FS	150
Ultimate Overload	%FS	300
Standard Cable Length	m	10 (10t) , 20 (25t ~ 450t)

*Dimensions:*

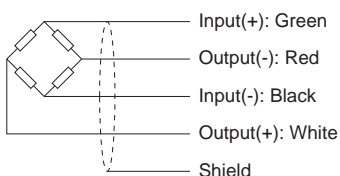
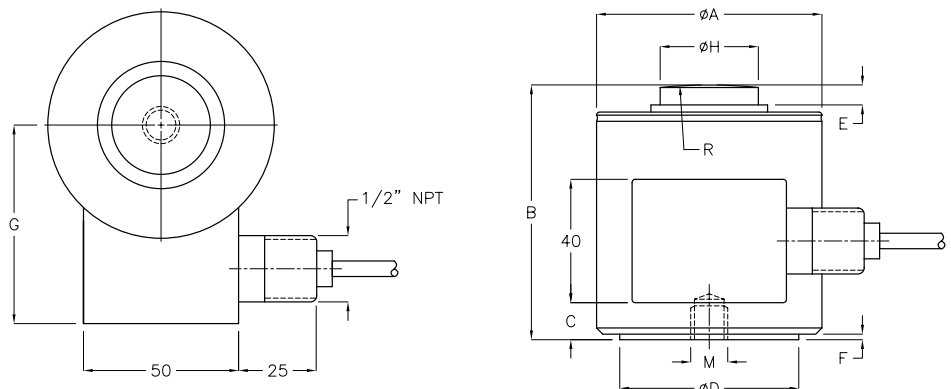

CAP.(t)	A	B	C	D	E	F	G	H	M	R
10,25	73.0	82.5	12.0	58	6.5	1.8	64.0	31.8	M12x1.75(11 Deep)	152.0
40,60	105.0	127.0	34.0	82.5	8.0	11.0	87.0	58.7	M20x2.5(20 Deep)	152.0
100	152.4	184.2	72.3	123.8	23.6	21.8	108.2	79.2	M20x2.5(20 Deep)	432.0
225	164.0	229.0	72.3	148.0	26.0	21.8	108.0	93.7	M20x1.5(25 Deep)	400.0
450	177.0	304.5	97.0	165.1	26.0	21.8	115.0	139.7	M20x1.5(32 Deep)	1143

All dimensions: mm.